

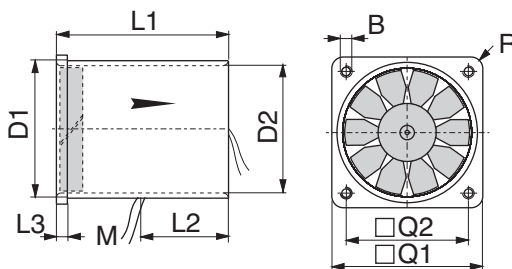

**Axiallüfter**  
**Axial Fans**  
**Ventilateurs axial**

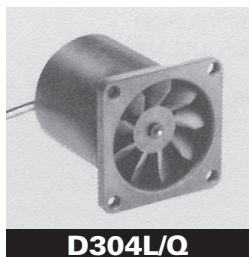

**D301L, D303L, D304L 12 VDC**

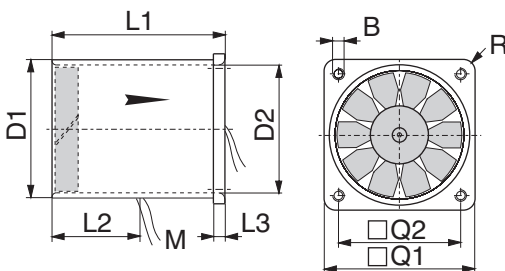
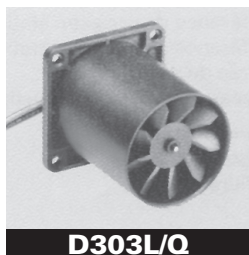
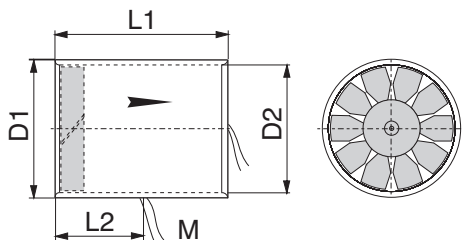
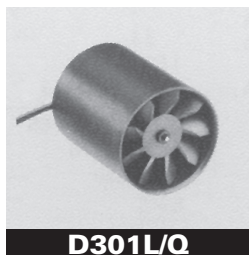
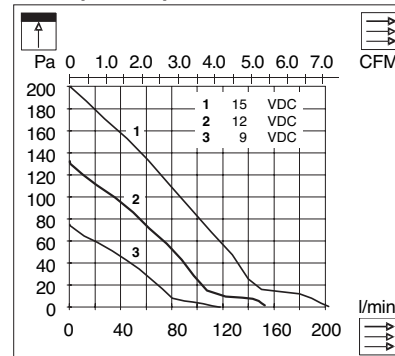

**D301L, D303L, D304L 24 VDC**

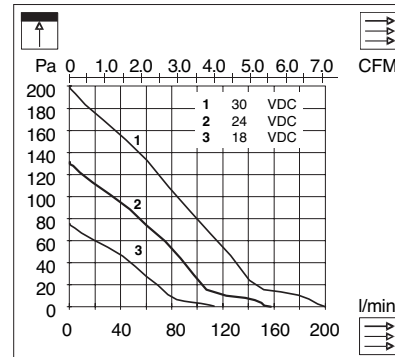

**D301Q, D303Q, D304Q 12 VDC**

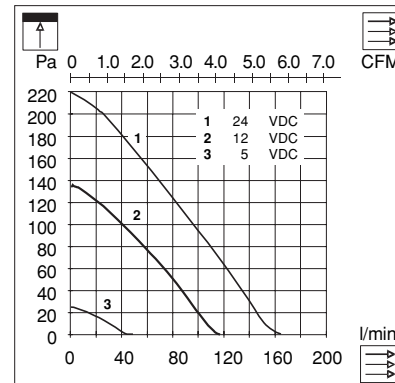

D300	mm	inch
D1	30	1.181
D2	27.5	1.083
L1	36	1.417
L2	18	0.709
L3	3	0.118
B	2.6	0.102
Q1	34	1.338
Q2	28	1.102
R	3	0.118



## Technische Daten

## Technical data

## Caractéristiques techniques

Die D300Q-Baureihe ist mit einem bürstenlosen Motor und einem externen Elektronikmodul ausgerüstet (3 Litzenversion; + Vcc, Gnd, Tachosignal)

- sehr lange Laufzeit
- Spannungsbereich 5 – 24 V DC
- Tachosignal
- Strombegrenzung

Option: 10 Litzen Ausgang mit weiteren Funktionen

The serie D300Q ist equipped with a brushless motor, and an external electronic modul (3 leadsversion; + Vcc, Gnd, tachosignal)

- Long life
- voltage range 5 – 24 V DC
- tacho signal
- current limitation

Option: 10 leads-version with further functions

La série D300Q est équipée d'un moteur "brushless" avec module électronique externe, (3 filsversion; + Vcc, Gnd, tachosignal)

- Usage longue vie
- gamme de tension 5 – 24 V DC
- signal tacho
- limite de courant

Option: version 10 fils avec fonctions supplémentaires

Types			D301L/D303L/D304L		D301Q/D303Q/D304Q	
<b>U</b>	U <sub>N</sub>	V	<b>12</b>	<b>24</b>	<b>12</b>	
	U	V	9...15	18...30	5...24	
<b>I</b>	I <sub>N</sub>	mA	48	22	60	
	I <sub>max</sub>	mA	60	27	75	
<b>O</b>	I <sub>block</sub>	A	0.9	0.45	0.98	
<b>P</b>	P <sub>N</sub>	W	0.58	0.53	0.72	
	n	min <sup>-1</sup>	13'750	13'750	14'200	
	∇	l/min; CFM	146/5.16	146/5.16	120/3.40	
	p	Pa	130	130	130	
	LpA	dB(A)	42	42	48	
<b>MTTF</b>	MTTF	hr	5'000		25'000	
	T	°C/F	-20...+65 / -5...+150		170	
	m	g/oz.	32/1.13		30/1.06	
	Lead Length	mm/inch	210/8.268 (AWG 26)		220/8.66 (AWG 26)	
	Housing Material		PPO UL-94V-1		PPO UL-94V-1	
	Sleeve Bearing		•		-	
	Ball Bearing		-		•	
	Brushless Motor		-		•	
	Flat Finger Guard		-		-	
	Circular Finger Guard		-		-	

### Zusätzliche Funktionen 10 Litzen Version (R-Version)

- Analog Ausgang (variable Drehzahl)
- PLL (konstante Drehzahl)
- Stop-Funktion
- Richtungswechsel
- NOS
- Tachosignal

### Additional Functions 10 Lead Version (R-Version)

- Analog output (variable speed)
- PLL (constant speed)
- Brake function
- Direction
- NOS
- Tacho signal

### Functions supplémentaires version à 10 fils (R-version)

- PWM (vitesse variable)
- PLL (vitesse constant)
- Function stop
- Changer de direction
- NOS
- Signal tacho

Q-Version: bürstenloser Motor mit externer Elektronik  
Q-Version: brushless motor with external electronics  
Q-version: moteur sans brosse avec électronique extérieure

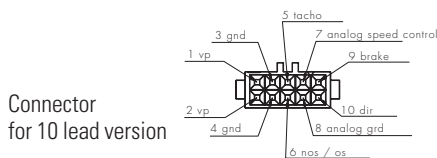

Connector for 10 lead version

Typ: Tyco V23535-A3280-101

